

# Soils Map

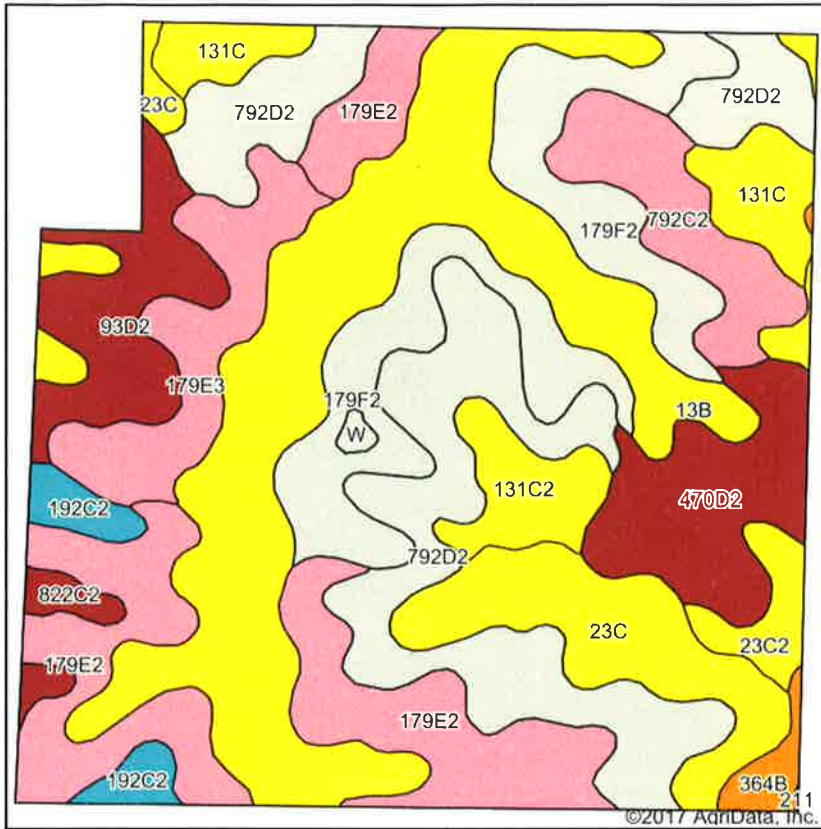

Soils data provided by USDA and NRCS.

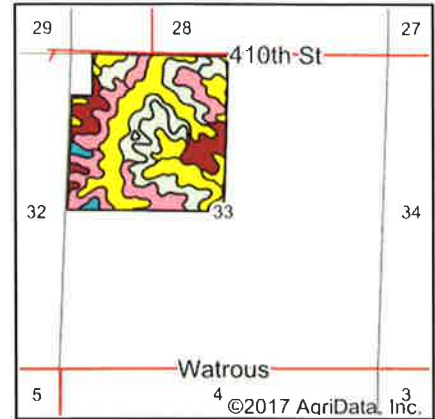

State: **Iowa**  
 County: **Lucas**  
 Location: **33-71N-21W**  
 Township: **Benton**  
 Acres: **149.79**  
 Date: **1/18/2018**



Maps Provided By  
  
 CUSTOMIZED ONLINE MAPPING  
 © AgriData, Inc 2017 www.AgrIDataInc.com



Area Symbol: IA117, Soil Area Version: 25

Code	Soil Description	Acres	Percent of field	CSR2 Legend	Soil Drainage	Non-Irr Class *c	CSR2**	CSR
13B	Zook-Olmitz-Vesser complex, 0 to 5 percent slopes	29.63	19.8%		Poorly drained	IIw	68	53
792D2	Armstrong clay loam, 9 to 14 percent slopes, moderately eroded	23.51	15.7%		Somewhat poorly drained	IVe	5	13
179E2	Gara clay loam, 14 to 18 percent slopes, moderately eroded	20.33	13.6%		Well drained	VIe	23	33
179F2	Gara clay loam, 18 to 25 percent slopes, moderately eroded	17.15	11.4%		Well drained	IVe	11	13
23C	Arispe silty clay loam, 5 to 9 percent slopes	11.19	7.5%		Somewhat poorly drained	IIIe	66	55
470D2	Lamoni-Shelby complex, 9 to 14 percent slopes, moderately eroded	8.94	6.0%		Somewhat poorly drained	IVe	34	25
179E3	Gara clay loam, 14 to 18 percent slopes, severely eroded	7.70	5.1%		Well drained	VIe	21	30
93D2	Shelby-Adair complex, 9 to 14 percent slopes, moderately eroded	7.24	4.8%		Well drained	IVe	34	35
792C2	Armstrong clay loam, 5 to 9 percent slopes, moderately eroded	6.51	4.3%		Somewhat poorly drained	IIIe	24	27
131C	Pershing silt loam, 5 to 9 percent slopes	5.42	3.6%		Somewhat poorly drained	IIIe	65	49
131C2	Pershing silty clay loam, 5 to 9 percent slopes, moderately eroded	3.91	2.6%		Somewhat poorly drained	IIIe	62	45
23C2	Arispe silty clay loam, 5 to 9 percent slopes, moderately eroded	2.81	1.9%		Somewhat poorly drained	IIIe	62	50
192C2	Adair clay loam, heavy till, 5 to 9 percent slopes, moderately eroded	2.46	1.6%		Somewhat poorly drained	IIIe	48	30
822C2	Lamoni silty clay loam, 5 to 9 percent slopes, moderately eroded	1.40	0.9%		Somewhat poorly drained	IIIe	36	30
364B	Grundy silty clay loam, 2 to 5 percent slopes	1.29	0.9%		Somewhat poorly drained	IIe	72	75
W	Water	0.30	0.2%				0	0
<b>Weighted Average</b>							<b>36.2</b>	<b>33.8</b>

\*\*IA has updated the CSR values for each county to CSR2.

\*c: Using Capabilities Class Dominant Condition Aggregation Method

Soils data provided by USDA and NRCS.